

Ernest J. Wagner
Bridgeport Nebraska
2025 Gilbert Maintenance
Engineer. State of Nebraska
Department of Roads + Irriga-
tion. Bridgeport Nebraska

Robert E. Wauland
1381 Browning Ave.
Salt Lake City Utah, U.S.A.

RALPH WESTERVELT
TRUMANSBURG
NEW YORK, U.S.A.

Capt. A. Cant
"The Croft"
Keir Street
Perth
Scotland

Feb 16th & 17th Dive bombers close
" 19th Bombs close
April 3rd Kawasaki Area
May 3rd "Last all clear" (not for us)
July 13th Misshin bombed also Mitsui
July 25 Mitsui camp bombed out
(22 killed - 8 injured)

December 20th 1944 Moved to Misshin Camp
{ 30 from Kawasaki? No 242
{ 40 from Omoni }

June 30th Moved to Mitsui Camp No 28
Italians & Norwegians arrived
a few days later from Shanghai

July 30th 1943 2 men died of drinking methyl
alcohol

Oct 23rd 42 Started at Misshin Flour Mills
March 44 Transferred to Machine Shop
Aug 16th all over

U.S.S. YORK TOWN - PLANE CREW

LEOIT JACK DORAN

MAPLEWOOD N.J.

GUNNER

NICK J. SALOPER

DUGOSEE P.A.

R.D.M.

"RED" LADER

BAKERSFIELD ~~CA~~ California

HIE Y A GANG

MAKES THIS WITH HELP (Benjo Paper)

James H. Begamun

109 Cleveland St

Melrose 76 Mass

88 Bomb Sq

Sorry there couldn't be more
Planes 133
122

Killed in No 2B Camp

25-7-45

Roea
Montgomery
Coyle

Mahoney
Strauch
Foote

Ferguson
Snakes
Taylor

Bentley
Runcie
Van Horn

Small

22 men killed

11 Bodies Found

11 Bombs in camp area

25 " in 250' square
road

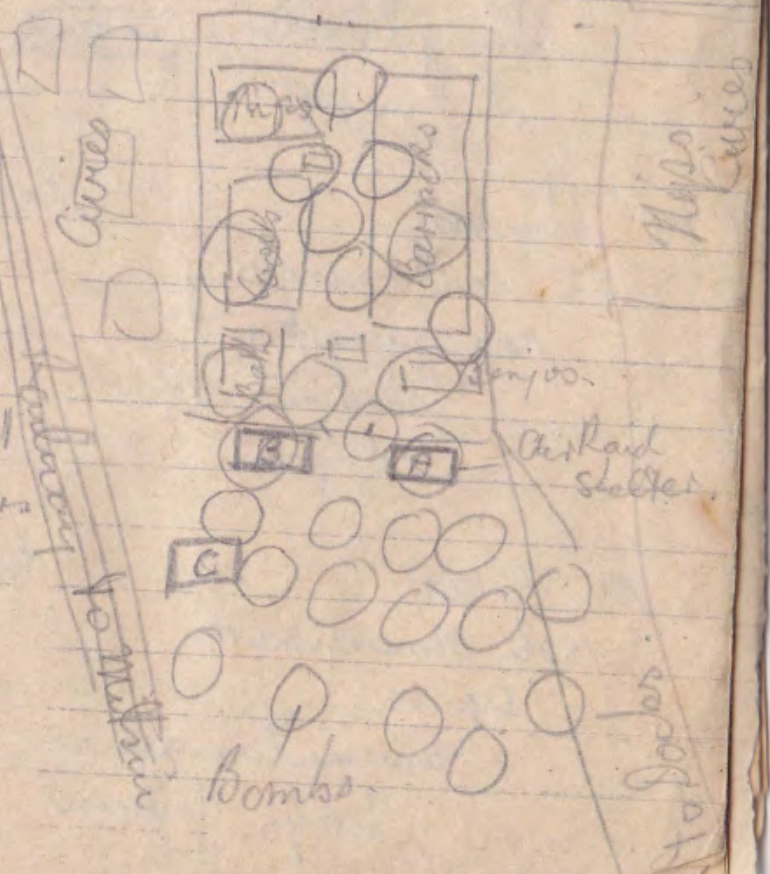

all killed except
1 in A+B shelters

all ok in C
4 was in @

Roadway to main camp

Missiles

Bombs

Killed 25 July 45

Emo J Carrey (USN)
Cpl AH Shelton USMC
PFC C Fedoroff 14th Bomb
PFC J Gomme 14th Bomb
P.F.G. Krawiecki USMC
PFC Paluch 5th Air Base
PFC Price 5 Air Base
PFC Wilkes 440th Bomb
L Ferguson 3rd W/Op
EG Mahoney 3rd W/Op
HT Raza s/s Rankin 2nd mate
A Runcie s/s Willardson 3rd mate
BJ Snater W/mcht USN
A Taylor RN. W/O
SM Bentley Sgt R/B paratrooper ss Rankin
A Focke M/M 10 M/M 10
D Small GMM USN
H. Struch CMM USN
R Van Horn 1st CPL USN
LH Cowle ss Rankin BR/O
L Montgomery ss Rankin 4th Eng
Mintals Italian -