

The 2nd Appended Map

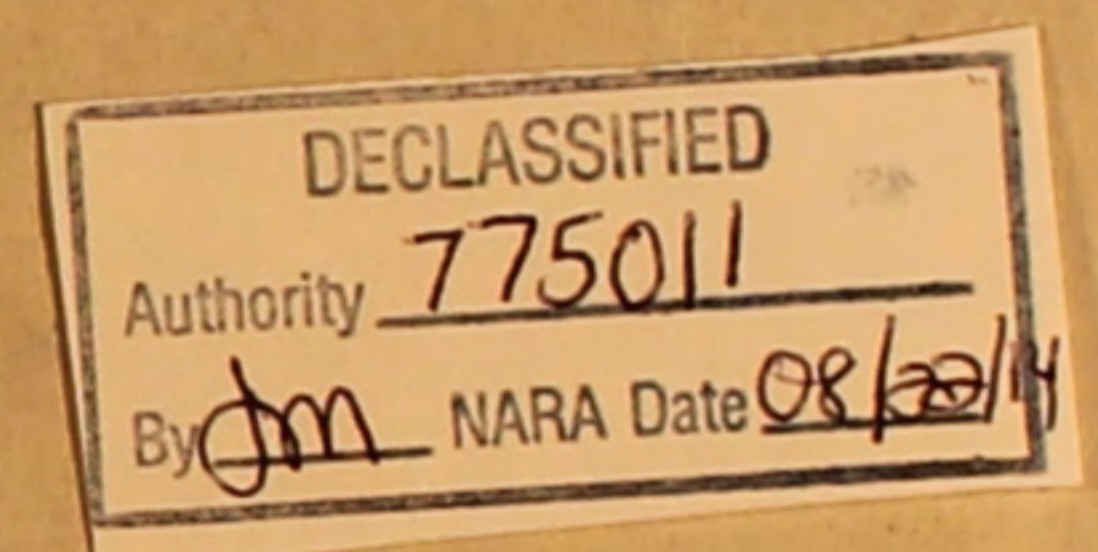

DECLASSIFIED
 Authority 775011
 By *gm* NARA Date 08/20/14

The Map of the 8th Detachment
 (FUKUOKA BRANCH CAMP 5B)

收容所配置圖

縮尺貳百分之壹

I, certify that the above blueprint was given to me by Mr. TOSHIO FUKAMI on 20 February 46 at 4th CAD Headquarters in FUKUOKA JAPAN and that it accurately represents FUKUOKA BRANCH CAMP NO. FIVE-B as it appeared on that date. I further certify that the below signature is the personal signature of Mr. TOSHIO FUKAMI and was signed in my presence.

TOSHIO FUKAMI

Toshio Fukami

MELVIN S. COHN, 2nd Lt. Inf
 Investigating Officer, War
 Crimes Investigation Div.

本圖ハ福岡縣田川郡川崎町古河大峰銃業所第五分所(福岡俘虜收容所)ノ配置圖ニ相違ナキコトヲ証明ス
 右 深見武男

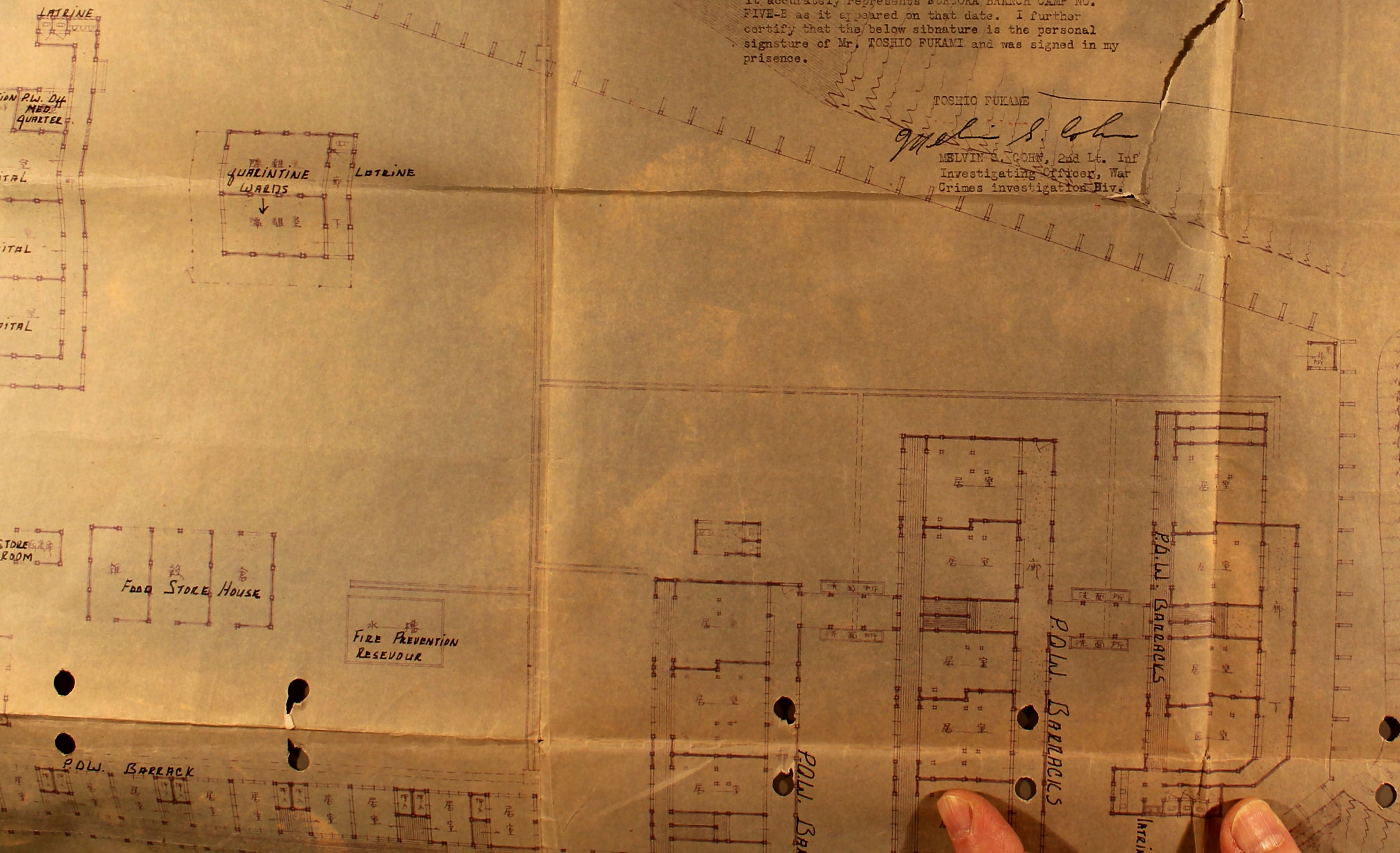

DECLASSIFIED
Authority 775011
By *dm* NARA Date 08/28/01

Vertical handwritten notes on the left margin, including the word 'm' repeated multiple times.

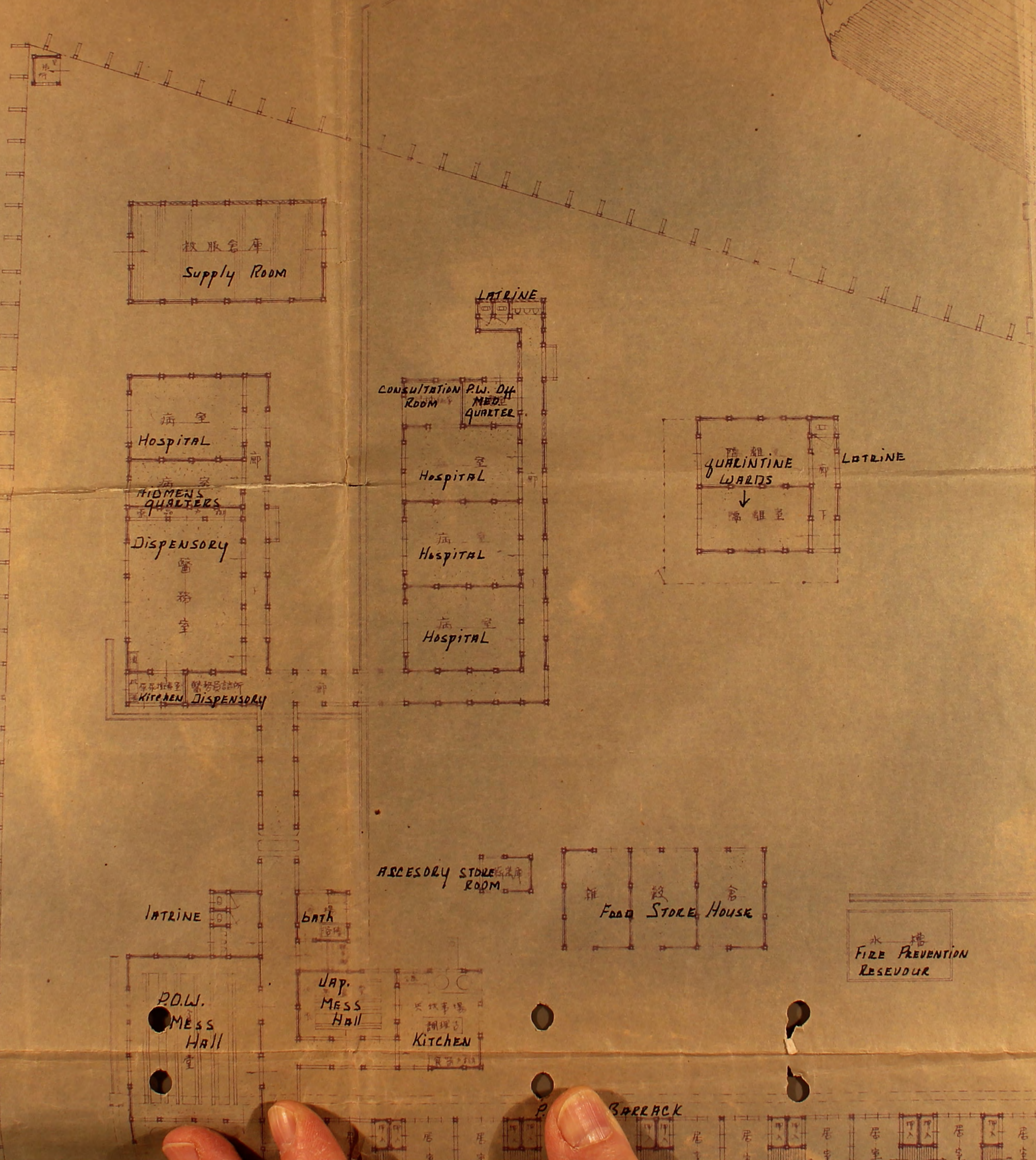

I, certify that the above blueprint was shown to me by Mr. TOSHIO FUKAMI on 23 February 1951 at 14th CAD Headquarters in FUKUOKA JAPAN and it accurately represents FUKUOKA BRIDGE CAMP FIVE-B as it appeared on that date. I further certify that the below signature is the personal signature of Mr. TOSHIO FUKAMI and was signed in his presence.

TOSHIO FUKAMI
Handwritten signature of Toshio Fukami
MELVIN J. COPE, Captain
Investigating Officer
Crimes Investigation Division

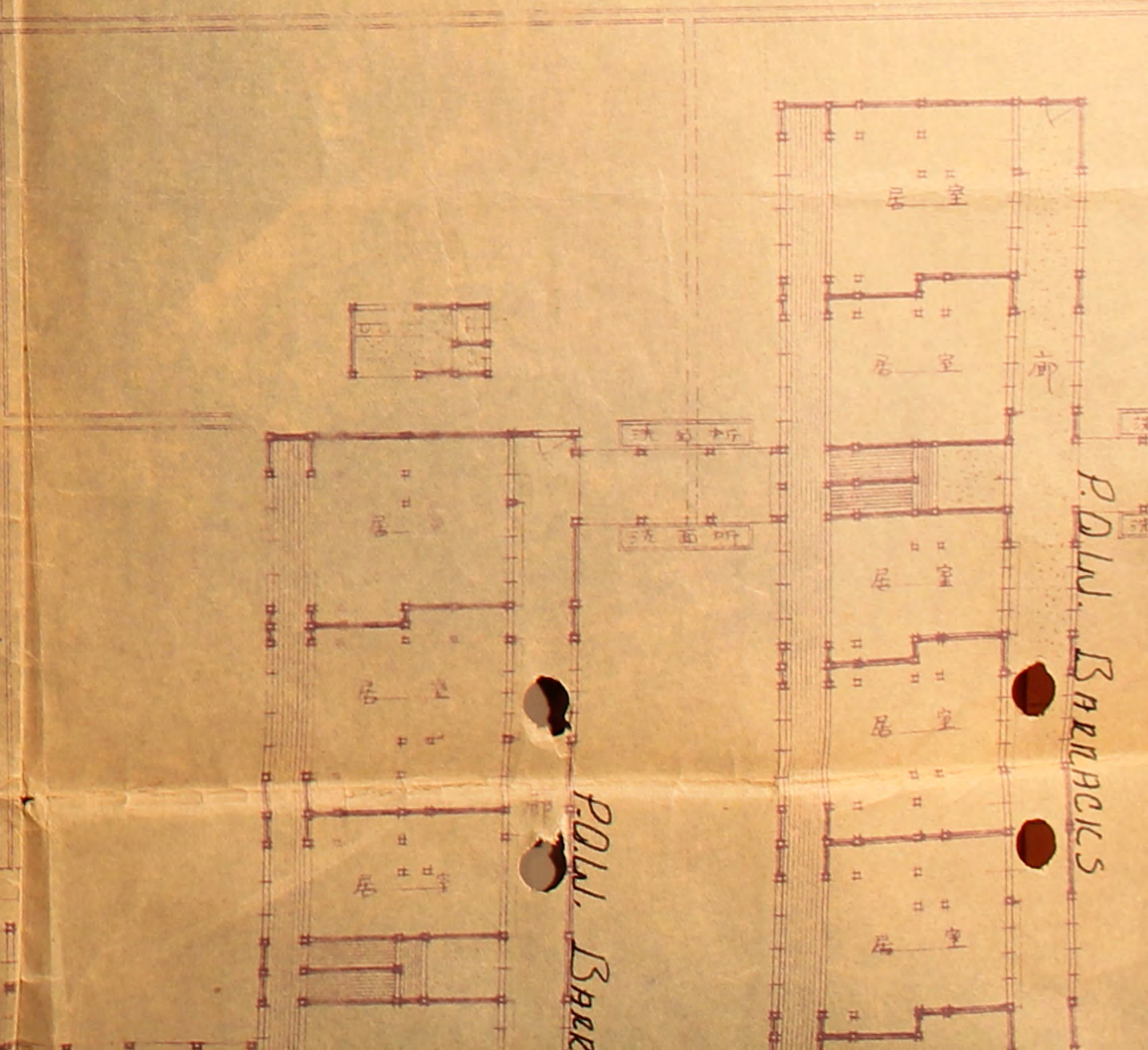

Copy shall remain lit
the exposed
the second
nothing
boards su
pins, tacks
Records ca
the walls c
be worn a
with items
Thank you
Still Picture

Copy remain
the ex
th
P
n
pins, t
Record
the wa
be wor
with it
Thank y
Still Pic

FRONT ENTRANCE TO COMPOUND

階下平面

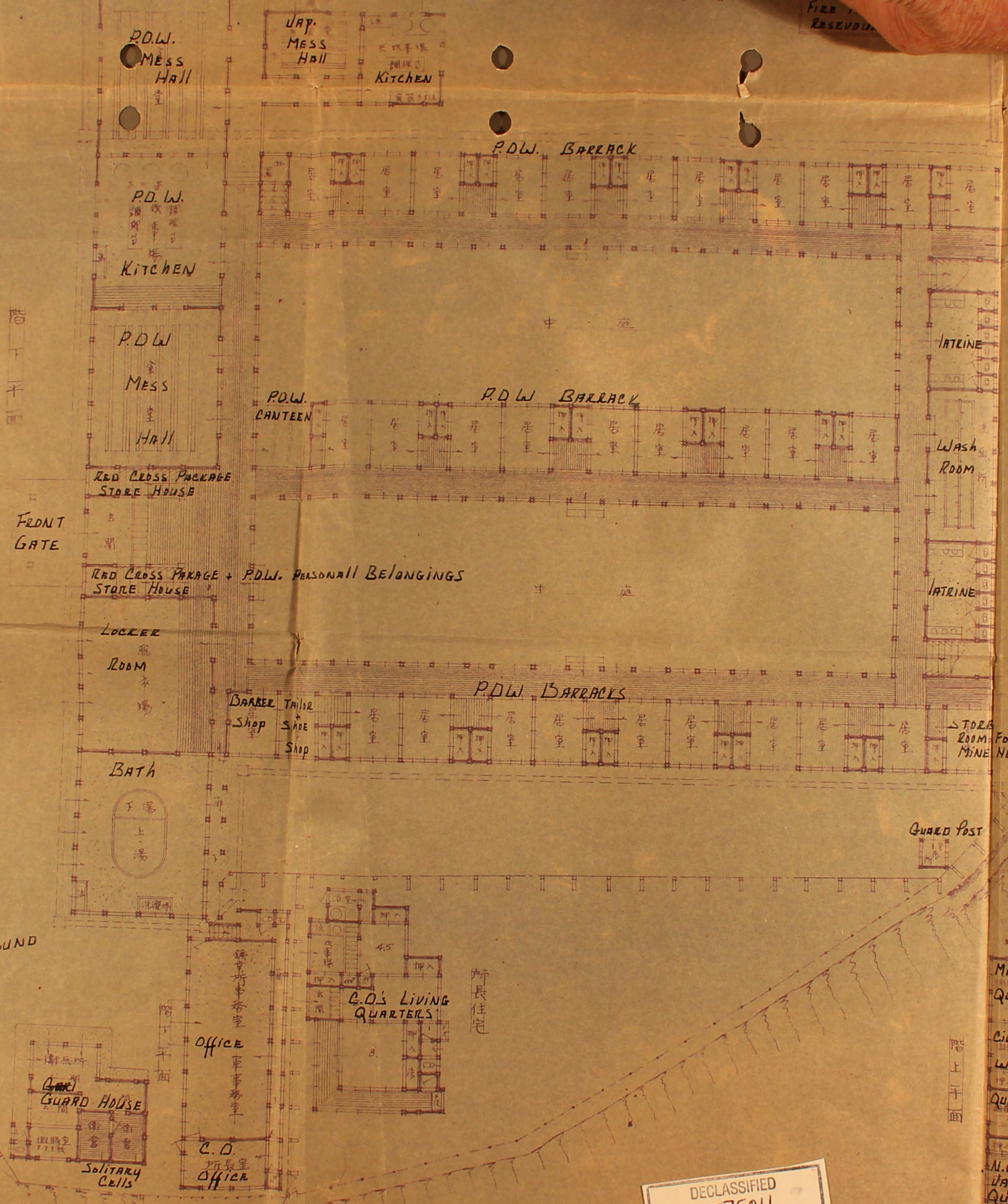

DECLASSIFIED
Authority 775011
By *jm* NARA Date 08/20/14

2ND FLOOR OF OFFICE

MINE EMPLOYEE
QUARTERS
CIVILIAN
WORKERS
QUARTERS
N.C.O.
JAP
QUARTERS

階上平面

